

ENTRANCE BORE DETAIL BB
SCALE 20/1

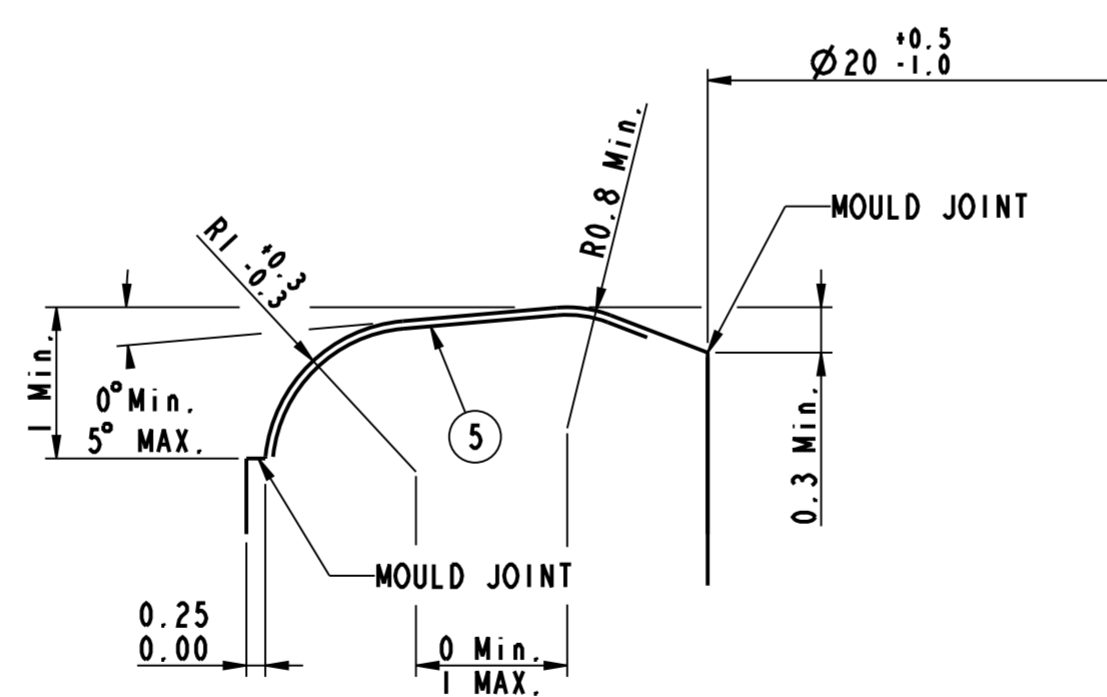

ENTRANCE BORE DETAIL PB
SCALE 20/1

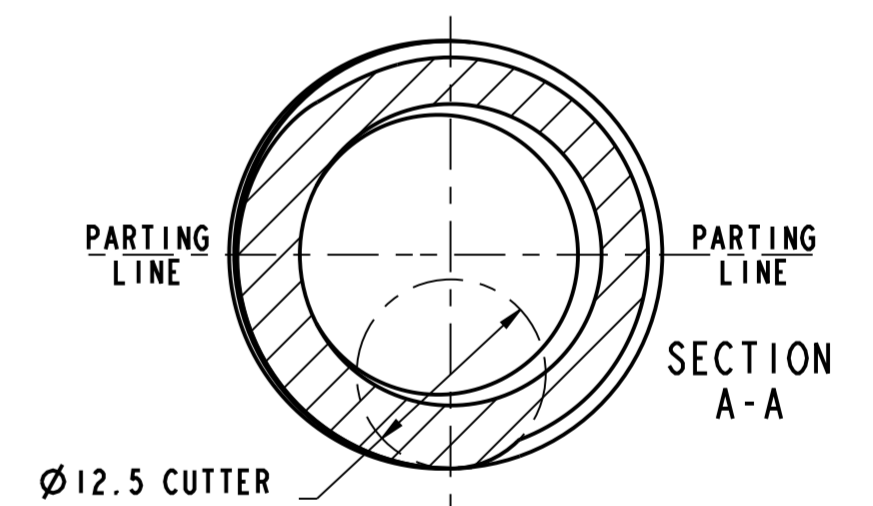

- ① ABSOLUTE OVALITY LIMITS
- ② LIMITS FOR MEAN DIAMETERS $\phi_{Max.} + \phi_{Min.}/2$
- ④ PITCH mm 3.63 - 7 THREAD/INCH
- ⑤ SEALING SURFACE =
- ⑥ THE ENTRANCE BORE IS MEASURED BETWEEN 1.5 mm AND 3 mm FROM THE TOP OF THE FINISH
- ⑦ THROUGH BORE $\phi 17$ mm

REV. No.	DESCRIPTION	DATE	DRW.	CHK.	REV. No.	DESCRIPTION	DATE	DRW.	CHK.
7	STANDARDIZED FOR EU	19.07.12	GP						
6	REPLACED IN SMART ASSEMBLY VERSION - EDITION 10/08-	30.05.08	OB	LL					
5	MODIFIED AS PER NORMATIVE GME 30.13 EXPERIMENTAL 02/07	14.08.07	PP						
4	MODIFIED AS PER NORMATIVE CE.T.I.E. DIMENSION FROM 59 TO 59.5 AND BORE DIAMETER FROM 19 TO 20	23.03.06	PP						
3	MODIFIED AS PER NORMATIVE CE.T.I.E. DIMENSION FROM 59.5 TO 59	15.10.04	PP		8	TRANSFER BEAD COSTRUCTION UPDATED AS PER CETIE NORM 30.12 EXPERIMENTAL 03/2012-08/13	07/01/12	GP	
2	MODIFIED AS PER NORMATIVE CE.T.I.E.	22.04.04	AM						

COUNTRY FINISH CODE 5003S			EU.30.GME 30.13.H218.0860 Deep BVS finish for still wine				EUROPE	
NOTES: THIS DRAWING IS THE PROPERTY OF O-1 AND MUST NOT BE REPRODUCED OR DISCLOSED WITHOUT O-1 WRITTEN AUTHORIZATION. ONLY TOLERANCED DIMENSIONS ARE GUARANTEED.			FIN. REF.: CETIE.30.13.REVI.03-2012 INSERT: NO DISPLACEMENT: DATE: 30-05-2008 APPR.:				SCALE 5:1	FINISH SAP NUMBER 0860